

INSTALLATION INSTRUCTIONS VERTICAL MOUNT WALL SHUTTERS

Single Panel Shutter 14 Thru 30 Inch For Use With Snap-Fans 12 Thru 28 Inch

Read carefully before attempting to assemble, install, operate, or maintain the product described. Protect yourself and others by observing all safety information. Failure to comply with instructions could result in personal injury and/or property damage. Retain instructions for future reference.

1. Upon receiving shutter/dampers, check for both obvious and hidden damage. If damage is found, record all necessary information on the bill of lading and file a claim with the freight carrier. Check to make sure all parts of the shipments are accounted for.
2. Proper handling of shutter/damper during installation is essential to ensure normal operation.
 - Lift or handle the damper by the frame, do not lift using the blades or linkage. When lifting multiple sections assembled, use sufficient support evenly distributed. Do not drag, apply excessive bending, racking or twisting.
 - Do not install shutter/damper leaning forward or backward.
 - Do not install screws or any other mounting hardware into the shutter/damper frame that will interfere with the shutter/damper blades and prevent them from opening and/or closing properly.
 - Mounting hardware, caulking and other necessary installation materials are not included.
 - Installed shutter/damper must be free of misalignment, such as squeezing, stretching, out of square, racking, twisting, etc...These conditions will prevent the damper from operating properly.

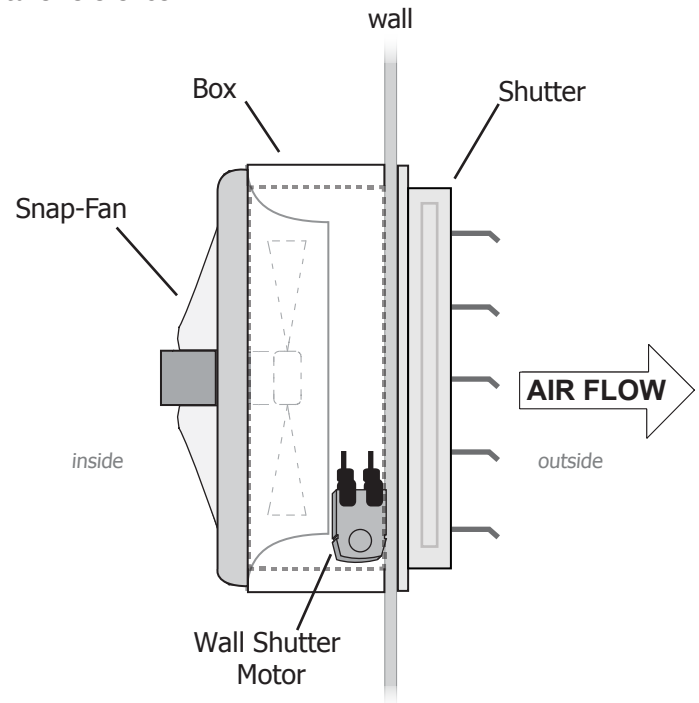

3. When installing a shutter/damper:
 - We generally recommend the hole opening to be 1/2" larger than the inside dimension (ID) of the width and height of the shutter/damper.
 - The shutter/damper frame should be mounted level and squarely on the outside wall. Care should be taken not to twist the shutter/damper frame. Never cover shutter/damper with siding or masonry work. Shutter should be mounted so it can be removed any time in case of damage.
 - Shutter/damper should operate as freely after installation as it did before.
 - Caulking compound is recommended between shutter/damper frame edges and the wall.
 - We recommend cleaning and lubrication shutter/damper at the same time that the fan is lubricated and cleaned.

LIMITED WARRANTY

All products manufactured are warranted by Solar National Air Propulsion (Snap-Fan) to be free from original defects in workmanship for a period of one year from date of shipment, under conditions of normal use and service. Snap-Fan will replace or repair any defective parts upon return to our plant, freight prepaid. This limited warranty will, in no way, include the payment of labor charges for field replacement of defective parts, installation, repairs of adjustments, or any other work done. Back charges will not be accepted for any reason unless Snap-Fan has given prior written permission, nor will Snap-Fan be responsible for consequential damages of any character, no limited warranty expressed or implied will supersede the foregoing.

MANUFACTURED FOR SOLAR NATIONAL AIR PROPULSION
PO Box 4461 Arcata, CA 95518
707 822 7627 snap-fan.com

FAN MOUNTING BOX DIMENSIONS

Use this guide to determine the dimensions of the box necessary to mount your Snap-Fan with the Automated Shutter (shutter with motor). Applications vary by system design. If you are installing fan into a building, visit snap-fan.com for hole diameter sizes.

12" SNAP-FAN

DC part#: 1200
AC part#: 1259

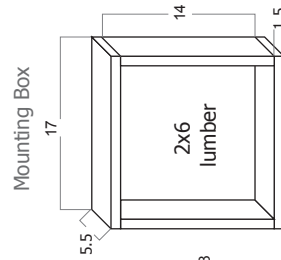
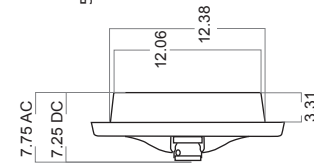
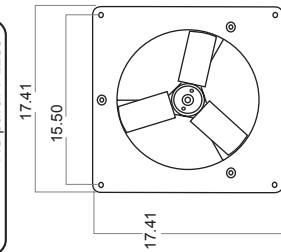

12" Snap-Fan SHUTTER

part#: 6900

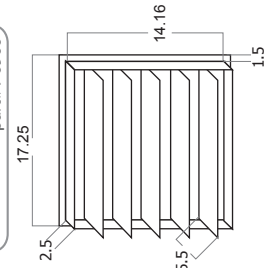

16" SNAP-FAN

DC part#: 1600
AC part#: 1659

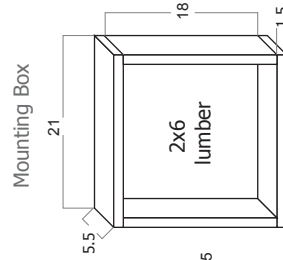
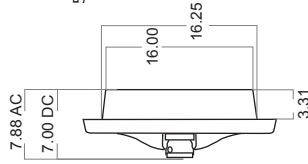
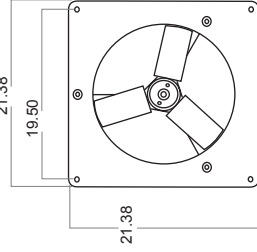

14" Snap-Fan SHUTTER

part#: 6904

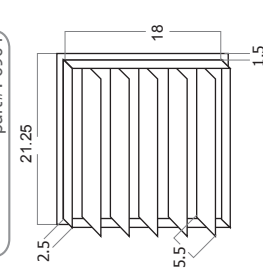

20" SNAP-FAN

DC part#: 2000
AC part#: 2059

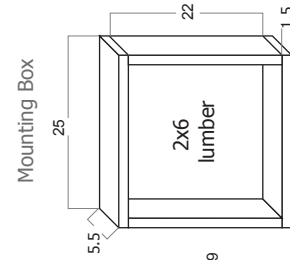
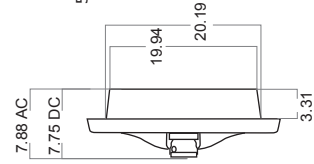
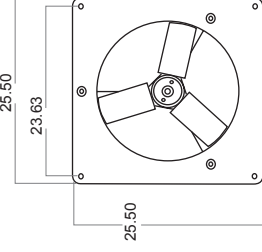

20" Snap-Fan SHUTTER

part#: 6905

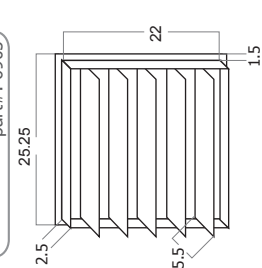

24" SNAP-FAN

DC part#: 2400
AC part#: 2459

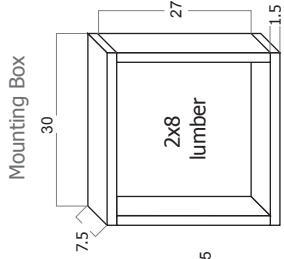
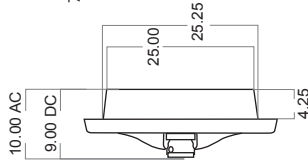
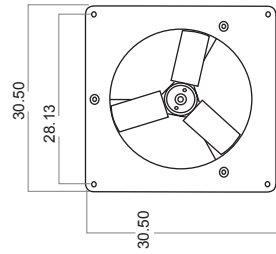

24" Snap-Fan SHUTTER

part#: 6906

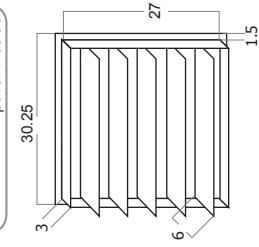

28" SNAP-FAN

DC part#: 2800
AC part#: 2859

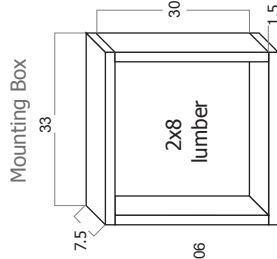
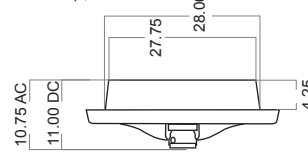
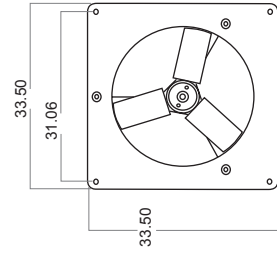

28" Snap-Fan SHUTTER

part#: 6901

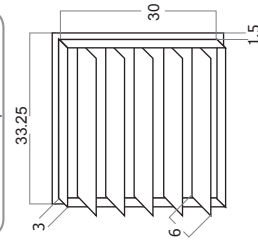

50" SNAP-FAN

W/ Automated Shutter part#: 5059-AS
W/ Non-Auto Shutter part#: 5059-NS

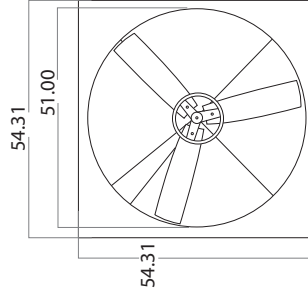
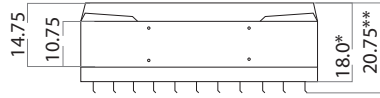

*with optional shutter
**with shutter open

Shutter Controls



Automated Shutter Motor for 12"-28" Fan

SHUTTER MOTOR
part#: 6912



Automated Shutter Motor for 50" Fan

SHUTTER MOTOR
part#: 6910



Passive Shutter Opener for 12"-28" Fan

SOLAR VENT
OPENER

If you ordered a 50 inch Snap-Fan, see installation instruction sheet attached to product.